



# OPERATION MANUAL

HYDRAULIC HAND PALLET TRUCK



## IMPORTANT NOTICE:

*Operator MUST read and understand the operating manual before using the hand pallet truck.*



# HYDRAULIC HAND PALLET TRUCK

## INSTRUCTIONS

This pallet truck is made of high quality steel and is designed for the horizontal lifting and transport of loads on a pallet or standardized containers on a level, fixed base.

For your safety and correct operation, please carefully read this instruction before using it.

NOTE: All of the information contained herein is based on data available at the time of printing.

We reserve the right to modify our own products at any time and without notice.

### 1. GENERAL SPECIFICATIONS

Capacity	kg	2500
Min. Fork Height	H(mm)	80
Max. Fork Height	H1(mm)	190-200
Max. Lifting Height	mm	110
Fork Width	B(mm)	550 or 685
Fork Length	L(mm)	1200
Fork Size	mm	150x55
Tandem Loading Wheel	mm	ED80x70
Steering Wheel	mm	0180x50
Material of Wheel	mm	Nylon
Net Weight	kg	73/75

## 2. TO ATTACH DRAW-BAR TO PUMP UNIT (SUPPLIED UNASSEMBLED)

If your pallet truck has arrived unassembled, please follow the instructions to attach the Drawbar. You will need following tools - a hammer, pliers, and spanner. Plus the following parts contained in the enclosed bag:- Axle (A105), two cotter pins (A106) (Note one is pre fitted in the axle A105)

NOTE: The number of draw-bar and pump should be the same.

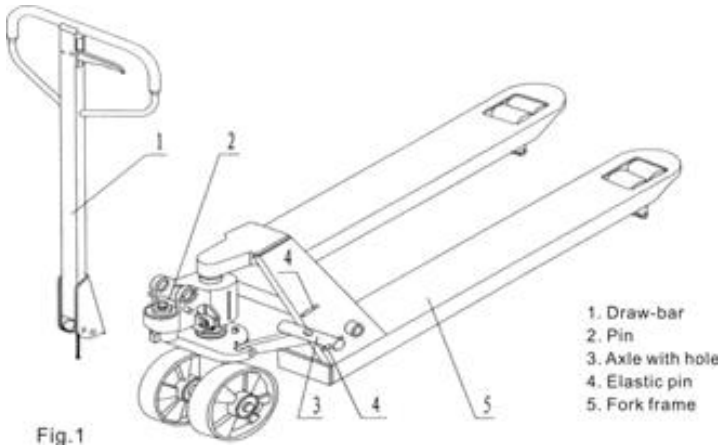

2.1 Insert the draw-bar onto the pump piston (A346), then use a hammer to insert the axle with hole (A105) into the hydraulic pump and draw-bar from the right to left. (See fig. 2).

2.2 Let control handle(A117) to the 'LOWER' position, then pass the adjusting nut(A104), adjusting bolt(A103) and chain(A102) through the hole of axle(A105) with your hand (See fig. 3).

2.3 Press the draw-bar (A110, A110B) down, take away the pin(#2) (See Fig. 1).

2.4 Let the control handle (A117) on 'RAISE' position, then raise the lever plate (A315) with the pin (#2) and insert the adjusting bolt(A103) into the front slot of lever plate (A315), note to keep the adjusting nut (A104) on the under side of the lever plate.

2.5 Use a hammer to tap another elastic pin (A106) into the axle with hole (A105).

The draw-bar is now assembled to the pump.

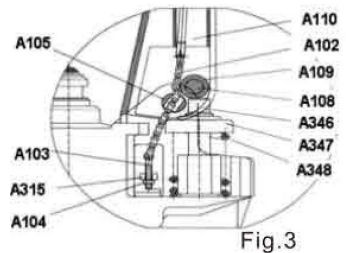
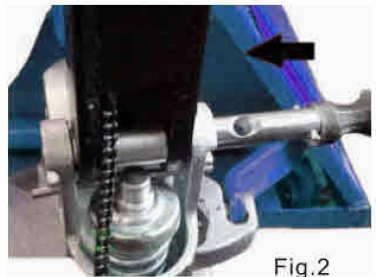

### 3. TO ADJUST RELEASE DEVICE

The control handle (A117) is located in at the top of the Draw Bar handle, it has three positions:

**Lower position** - RAISE the pallet forks when pumped.

**Middle Position:** DRIVE position – no movement of the forks when pumped.

**Top Position:** Lowers the pallet forks when handle is lifted, springs back to centre position when released.

If however they have been changed, you can adjust according to following step:

3.1 If the forks elevate while pumping in the DRIVE position, turn the adjusting nut (A104) on the adjusting bolt(A103) or screw(A318) clockwise until pumping action does not raise the forks and the DRIVE position functions properly.

3.2 If the forks descend while pumping in the DRIVE position, turn the nut(A104) or screw(A318) counter-clockwise until the forks do not lower.

3.3 If the forks do not descent when the control handle (A117) is in the LOWER position, turn the nut(A104) or screw (A318) clockwise until raising the control handle(117) lowers the forks. Then check the DRIVE position according to item 3.1 and 3.2 to be sure the nut (A104) and screw (A318) is in the proper position.

3.4 if the forks do not elevate while pumping in the RAISE position, turn the nut (A104) or screw (A318) counter-clockwise until the forks elevate while pumping in the RAISE position. Than check the LOWER and DRIVE position according to item 3.1, 3.2 and item 3.3.

### 4. MAINTENANCE

The pallet truck is largely maintenance-free.

#### 4.1 OIL

Please check the oil level every six months. The oil can be hydraulic oil: ISO VG32, its viscosity should be 30cSt at 400 C, total volume is about 0.41t.

#### 4.2 TO BLEED THE HYDRAULICS

The air may come trapped in the hydraulic oil because of transportation of the pump in a upturned position. It can cause that the forks not to elevate while pumping in the RAISE position. The air can be removed in the following way: hold the control handle (A117) on the LOWER position, then move the draw-bar up and down for several times.

#### 4.3 DAILY CHECK AND MAINTENANCE

Daily check of the pallet truck can limit wear as much as possible. Special attention should be paid to the wheels, the axles, as thread, rags, etc, may jam the wheels. The forks should be unloaded and lowered to the lowest position when the checks are completed.

#### 4.4 LUBRICATION

All bearings and shafts are fitted with long-life grease at the factory. Grease points should be checked and topped up if necessary every month with long-life grease, or when the bearings have been overhauled.

## 5 GUIDE TO SAFETY OPERATION

- 5.1 Operator should read all warning signs and instructions here and on the pallet truck before using this truck.
- 5.2 Do not use on a slopping ground.
- 5.3 Do not operate a pallet truck unless you are familiar with it and have been trained or authorized to do so.
- 5.4 Do not operate a pallet truck unless you have checked its condition. Giving special attention to the wheels or rollers, the draw-bar unit, the fork unit, the lever plate, etc.
- 5.5 To pull the truck, always move the control handle into the drive position. This makes the draw-bar easier to move and depressurizes the pump section of the hydraulics. This preserves the hydraulic seals and the valve components. A long service life can be expected.
- 5.6 Do not use the pallet truck to raise personnel.
- 5.7 Use the correct protective clothing, gloves and safety footwear.
- 5.8 Ensure people are at least 600mm clear of the truck when lowering the forks.
- 5.9 Do not load goods in an unstable manner as fig. 5/B .
- 5.10 Do not load over the maximum capacity.
- 5.11 Ensure vigilance is used when manoeuvring the pallet truck.

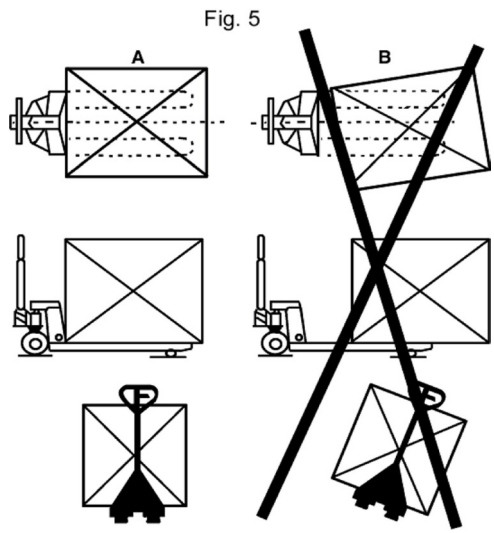
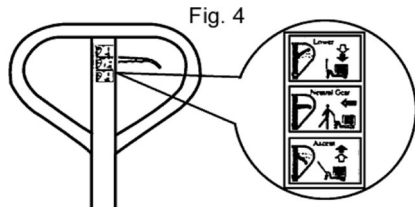

**6. TROUBLESHOOTING**

No.	Problem	Cause	Solution
1	The forks cannot be raised up to their maximum height.	<ul style="list-style-type: none"> <li>• Not enough hydraulic oil in the pump</li> </ul>	<ul style="list-style-type: none"> <li>• Top the unit up with hydraulic oil</li> </ul>
2	The forks cannot be lifted up	<ul style="list-style-type: none"> <li>• No hydraulic oil.</li> <li>• The oil has impurities in it.</li> <li>• The nut (114) is too high, keep the pumping valve open.</li> <li>• The system has air in it.</li> </ul>	<ul style="list-style-type: none"> <li>• Fill the pump with oil.</li> <li>• Change the oil.</li> <li>• Adjust the nut(A104) or screw (A318) (see 3.4)</li> <li>• Bleed the air out (see 4.2)</li> </ul>
3	The forks cannot be lowered.	<ul style="list-style-type: none"> <li>• The piston rod or pump body is damaged as a result of overloading or collision.</li> <li>• The fork have been kept raised for extended period, resulting in rusting or contamination of the rod.</li> <li>• The adjusting nut (114)is not in correct Position</li> </ul>	<ul style="list-style-type: none"> <li>• Keep the forks in the lowest position when not using and keep the rod lubricated.</li> <li>• Adjust the nut (A104) or screw (A318) (see 3.3)</li> </ul>
4	Leaks	<ul style="list-style-type: none"> <li>• Sealing parts worn or damaged.</li> <li>• Pump casing cracked or rod is worn</li> </ul>	<ul style="list-style-type: none"> <li>• Replace with the new one.</li> <li>• Replace with the new one.</li> </ul>
5	The fork descends without the lever being in the RELEASE position.	<ul style="list-style-type: none"> <li>• The oil has impurities in it which prevents the valve sealing.</li> <li>• Part(s) of the hydraulic system is/ are cracked or worn.</li> <li>• Air in the hydraulic oil.</li> <li>• Sealing parts worn or damaged.</li> <li>• The adjusting nut (A104) or screw (A318) is not in the correct position.</li> </ul>	<ul style="list-style-type: none"> <li>• Replace with new oil.</li> <li>• Inspect and replace the worn parts.</li> <li>• Bleed the air out. (See 4.2)</li> <li>• Replace with the new one.</li> <li>• Adjust the nut (A104) or screw (A318). (See 3.2)</li> </ul>

**NOTE: DO NOT ATTEMPT TO REPAIR THE PALLET TRUCK UNLESS YOU ARE TRAINED AND AUTHORIZED TO DO SO.**



## EC DECLARATION OF CONFORMITY

Hand Pallet Truk Type: TRUCK550  
TRUCK680

Date of Manufacture:

Is in Conformity with the following requirements:

Directives:

- 2006/42/CE
- 2006/95/CE
- 2004/108/CE

Manufacturer or his authorised representative in Community:

BLUERANGE  
PO BOX 29  
BOOTLE  
MERSEYSIDE L20 1EJ

Date: January 2024

Authorised signatory:

*Malcolm Lewis*

For and on behalf of BLUERANGE

**BLUERANGE**  
76 REGENT ROAD  
BOOTLE  
MERSEYSIDE L20 1BL

email: [sales@bluerangetools.com](mailto:sales@bluerangetools.com)  
phone: 0151 955 4726