

## MAINTENANCE NOTES

---

---

---

---



### PROTECT THE ENVIRONMENT

When this product reaches the end of its useful/working life it should be recycled in line with local policies and regulations. Take the product to your recycling centre to be disposed of in an environmentally friendly manner.

### IMPORTANT:

We reserve the right to update our product specification, data and parts with out notice, as part of our continuous improvement policy.

We accept no liability for any incorrect use of this product.

Document BRCB – Dated 1<sup>st</sup> May 2021 Rev 1.2

# **BLUERANGE®**

## **CHAIN BLOCK**

### **OPERATING INSTRUCTIONS**



### Model No's:

BRCB1T ~ 1 Tonne x 3m

BRCB3T ~ 3 Tonne x 3m

BRCB5TX3M~ 5 Tonne x 3m

BRCB5TX6M~ 5 Tonne x 6m



### IMPORTANT:

KEEP THESE INSTRUCTIONS SAFE FOR FUTURE REFERENCE.

READ INSTRUCTIONS CAREFULLY, FOLLOW THE SAFE WORKING PRACTICES OUTLINED AND HEED THE WARNINGS. FAILURE TO DO SO MAY LEAD TO PERSONAL INJURY OR DAMAGE THE PRODUCT.

**SAFETY**

Before use ensure the chain block is in good working order and not damaged. If the chain block is damaged remove from service immediately. Damaged parts should be repaired or replaced before the unit is used again. This should be undertaken using genuine parts by a trained technician.

- **Ensure** support for the chain block can carry at least 1 1/2 times the hoists WLL.
- **Ensure** the chain block is suitably rated to carry the designated load.
- **Ensure** all but essential personnel keep a safe distance while the chain block is in use.
- **Ensure** the chain block work area is well lit, clean and free from clutter.
- **Ensure** work area floor is sound and not slippery so a firm footing can be maintained.
- **Ensure** only competent personnel operate the chain block.
- **Ensure** load sling(s) are fully engaged in the load hook and safety bar is closed before lifting. Operate the hoist smoothly **DO NOT** allow the load to fall freely – even for short distances
- **Ensure** brake is operating by stopping when the load has been raised a short distance (10cm) and ensuring there is no downward creeping of the load.
- **Ensure** chain block is maintained as per these instructions.
- **Ensure** a risk assessment is undertaken before deploying the chain block

**DANGER**

Use the chain block for lifting only – never to support the lifted load for other work tasks eg welding..

- **DO NOT** exceed the rated capacity of the chain block..
- **DO NOT** allow untrained personnel to operate the chain block.
- **DO NOT** use two or more chain blocks to lift a load – use a single hoist of the correct rated capacity.
- **DO NOT** drag a load across the floor with the chain block – place the chain block directly above the load.
- **DO NOT** allow personnel to stand or pass underneath a raise load..
- **DO NOT** use the chain block in a explosive or corrosive atmosphere.
- **DO NOT** use when under the influence of drugs, alcohol or medication that may cause drowsiness.
- **DO NOT** use the chain block if damaged.
- **DO NOT** use the chain block if any chains are kinked or knotted.



Refer to instructions



Wear protective gloves



Wear safety footwear

**IMPORTANT-CAUTION**

Install, operate and maintain this equipment in accordance with these instructions. Failure to do so may lead to personal injury, damage to the Chain Block and invalidation of the warranty.

Take immediate action to repair or replace damaged parts by contacting your supplier. Ensure that all accessory lifting devices are suitably certified. If Chain Block is damaged, remove from service immediately.

Read thoroughly the contents before use and keep this handbook for future use.

**APPLICATION**

This Chain Block is a portable lifting device easily operated by hand chain . It is suitable for use in a wide range of industrial and commercial settings for the installation of equipment, as well as for loading and unloading goods. The unit is designed for use in a workshop/garage or warehouse environment.

Being hand operated it is ideal for use when no power supply is available.

It is suitable for monorail overhead conveying system, hand travelling crane and jib crane

**FEATURES**

The Bluerange Chain Block comes with five outstanding design and service features:-

1. Safe and reliable operation with minimum maintenance.
2. High operating efficiency means less user effort.
3. Light weight and easy to handle.
4. Attractive compact design.
5. Long service life.

**PRECAUTIONS BEFORE INSTALLATION**

1. Inspect the unit carefully for any damage that may occur during shipping. Check for loose, missing or damaged parts.
2. The chain block is shipped assembled.

3. Confirm that the structure supporting the hoist is strong enough to support the rated capacity of the Chain block with a safety factor of at least 1 1/2 times the WLL of the chain block .
5. The larger models are heavy , it is recommended that two people lift these models and hook them onto the support to be used.

**PRECAUTIONS BEFORE USE**

1. Check and be sure that the load chain is not twisted, kinked, damaged or worn. The load chain must always mesh correctly with the load sheave.



2. Lubricate the whole load chain with machine or gear oil.
3. Confirm that the brake is functioning properly. Lift the load up 10cm, stop to confirm the brake hold the load. If it does not – **DONOT** use the unit until it is serviced/repared.

OPERATION INSTRUCTIONS

**MAINTENANCE**

NOTE: The Chain Block MUST be maintained in accordance with these instructions. Maintenance and repairs should only be carried out by qualified people.

1. Clean off any dirt on the lever hoist after use and store it in safe, dry place when not in use.
2. Clean the parts with kerosene and lubricate the gears and bearings with grease once a year.
3. Align the "0" marks of the two gears (part no.4) while assembling, as shown below.

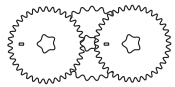

4. While assembling the brake mechanism, take care to mesh the slanting teeth of the ratchet disc and the pawl. Make sure that the pawl is positively secured by the spring. Then turn the handle clockwise after screwing it onto the driving shaft, it must press the ratchet gear and the brake disc on the brake Seat. Turning it counter clockwise there should be clearances between the ratchet disc and the friction disc.

5. Transition fit is applied to the stay and the left side plate (13). **Do not** dismantle
6. After cleaning and repairing, the hoist should be subjected to no-load test and load test by a competent person.

The lever hoist can be put returned operation after it has been tested and found to be in good condition.

7. Ensure the brake friction surfaces are not contaminated while lubricating or operating the Block. The brake mechanism should be inspected regularly to prevent failure of the System.
8. Store the hoist correctly protected from rain and moisture.

**DO NOT** use two or more chain blocks to lift a load.



**DO NOT** operate with twisted or knotted chain



**DO NOT** use excessive force on the chain. Stop and inspect the block for issues.

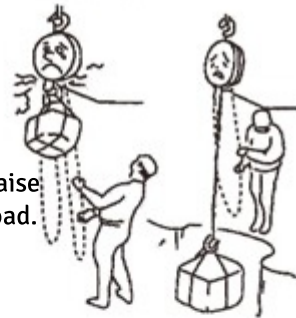

**DO NOT** over raise or lower the load.



**DO NOT** bind the load with the load chain – use suitable lifting slings.

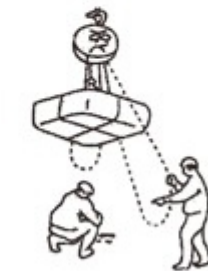

**DO NOT** stand or pass under a raised load.

**SPECIFICATIONS**

Item No.		BRCB1T	BRCB3T	BRCB5T X 3M	BRCB5T X 6M
capacity	t	1	3	5	5
Standard lift	m	3	3	3	6
Running test load	kN	15	45	75	75
Effort required to lift rated load	N	300	350	400	400
Strands of load chain		1	2	2	2
Load chain size	mm	6x18	7.1x21	9x27	9x27
Dimensions (mm)	A	153	152	183	183
	B	146	200	253	253
	C	350	465	650	650
	D	38	52	66	66
	K	23.5	35.4	46	46
Net weight	kg	10.7	20	34.4	47.9
Packing measurement	cm	26x19x19	34x24x19	49x29x23	49x29x23

Data subject to change without notice

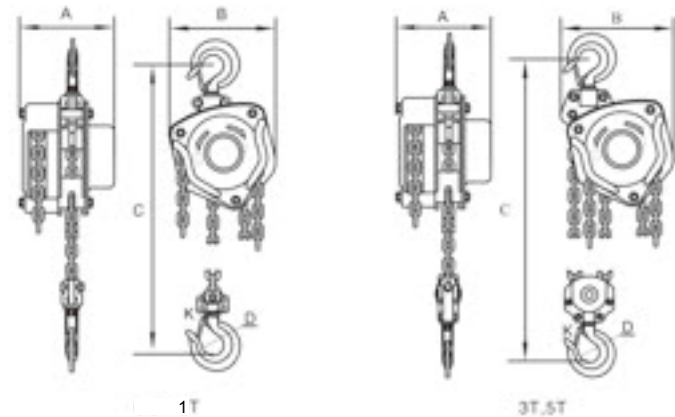

**EXPLODED DIAGRAM**

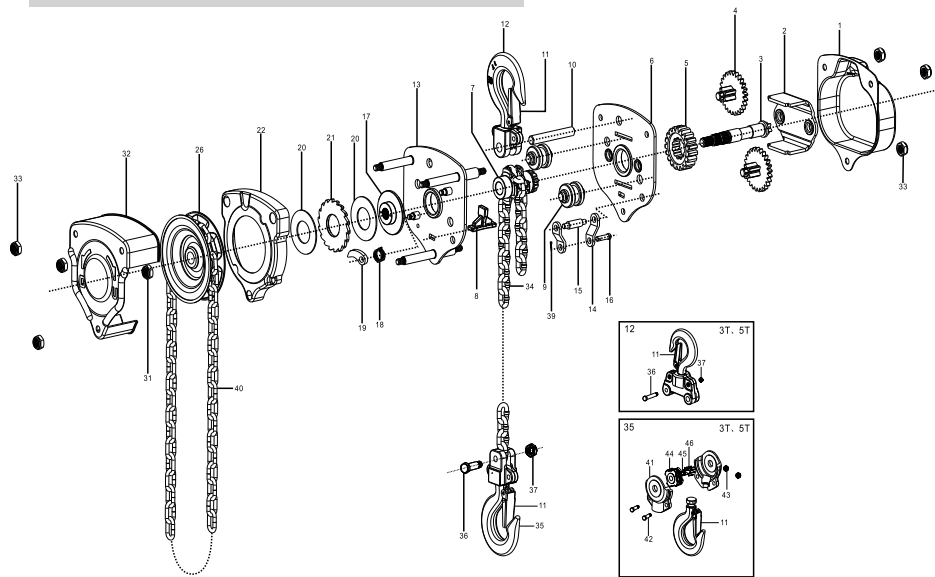

- |                               |                          |                               |
|-------------------------------|--------------------------|-------------------------------|
| 1. Gear Cover                 | 17. Friction Hub         | 41. Hook Holder               |
| 2. Gear Plate Assembly        | 18. Retaining Spring     | 42. Bolt for hook holder      |
| 3. Pinion Shaft               | 19. Retaining Pawl       | 43. Nut for hook holder       |
| 4. Gear Set                   | 20. Brake Disc           | 44. Idle Sheave               |
| 5. Lift wheel Gear            | 21. Ratchet Gear         | 45. Idle Sheave Axle          |
| 6. Gear Side Plate Assembly   | 22. Brake Cover          | 46. Needle                    |
| 7. Lift wheel                 | 26. Hand wheel           | 47. Steel Ball                |
| 8. Chain Stripper             | 31. Nut for Pinion Shaft | 48. Connecting Sleeve         |
| 9. Chain Guide                | 32. Hand wheel Cover     | 49. Nut for Connecting Sleeve |
| 10. Upper Hook Pin            | 33. Nut for Cover        | 50. Hook                      |
| 11. Latch Kits                | 34. Load Chain           | 51. Connecting Axle           |
| 12. Upper Hook Assembly       | 35. Lower Hook Assembly  | 52. Upper moving axle         |
| 13. Brake Side Plate Assembly | 36. Chain Bolt           | 53. Chain suspender           |
| 14. Chain Stop                | 37. Chain Nut            | 54. Bottom Hook Holder        |
| 15. Chain Stop Bolt           | 39. Split Pin            | 55. Upper Hook Holder         |
| 16. Chain Stop Pin            | 40. Hand Chain           | 56. Idle Sheave               |

Data subject to change without notice

Dual Document

**EC DECLARATION  
OF CONFORMITY**



**UKCA DECLARATION  
OF CONFORMITY**



**Designation:** Chain Block 1000kg, 3000kg, 5000kg

**Model No:** BRCB1T, BRCB3T, BRCB5TX3M, BRCB5TX6M

**Complies with the following directives:**

Machinery Directive 2006/42/EC

The conformity assessment procedure followed was in accordance with EN ISO 13157A1:2009

**Manufacturing Date/serial number :**

Please refer to product data label

Technical file holder : Bluerange

Authorised signatory

Dated: 11/05/2021

Signature:

*Malcolm Lewis*

Name: Mr Malcolm Lewis

Position: Brand Manager

Company:

Bluerange 76 Regent Road Bootle Merseyside L20 1BL